

Adjusting the Heel Resistance



1. Walk the patient to determine whether the stiffness of the heel is appropriate.
2. If desired, snap a heel wedge into place between the shank and the head of the heel shoulder bolt (refer to the pictures on the back of this page). Walk the patient again.

Note: for this step, it is not necessary to apply the adhesive that is supplied with the foot. The heel is held in place firmly enough to suffice for a temporary fitting situation.

3. To increase the stiffness of the heel, insert a larger heel wedge; to decrease the stiffness, insert a smaller heel wedge.
4. Once the appropriate heel wedge has been determined, clean the heel wedge and carbon heel with acetone, then permanently attach the heel wedge to the carbon heel (but not to the shank) using the instant adhesive that was provided with the foot.

Avoid getting acetone on the Fusion graphic on the shank. Acetone will destroy the graphic.



OHIO WILLOW WOOD®

free the body...free the spirit®

15441 Scioto Darby Road

Mt. Sterling, Ohio 43143 USA

Phone: 740.869.3377 or 800.848.4930

Fax: 740.869.4374 <http://www.owwco.com>

Adjusting the Heel Resistance



1. Walk the patient to determine whether the stiffness of the heel is appropriate.
2. If desired, snap a heel wedge into place between the shank and the head of the heel shoulder bolt (refer to the pictures on the back of this page). Walk the patient again.

Note: for this step, it is not necessary to apply the adhesive that is supplied with the foot. The heel is held in place firmly enough to suffice for a temporary fitting situation.

3. To increase the stiffness of the heel, insert a larger heel wedge; to decrease the stiffness, insert a smaller heel wedge.
4. Once the appropriate heel wedge has been determined, clean the heel wedge and carbon heel with acetone, then permanently attach the heel wedge to the carbon heel (but not to the shank) using the instant adhesive that was provided with the foot.

Avoid getting acetone on the Fusion graphic on the shank. Acetone will destroy the graphic.



OHIO WILLOW WOOD®

free the body...free the spirit®

15441 Scioto Darby Road

Mt. Sterling, Ohio 43143 USA

Phone: 740.869.3377 or 800.848.4930

Fax: 740.869.4374 <http://www.owwco.com>

Adjusting the Heel Resistance



1. Walk the patient to determine whether the stiffness of the heel is appropriate.
2. If desired, snap a heel wedge into place between the shank and the head of the heel shoulder bolt (refer to the pictures on the back of this page). Walk the patient again.

Note: for this step, it is not necessary to apply the adhesive that is supplied with the foot. The heel is held in place firmly enough to suffice for a temporary fitting situation.

3. To increase the stiffness of the heel, insert a larger heel wedge; to decrease the stiffness, insert a smaller heel wedge.
4. Once the appropriate heel wedge has been determined, clean the heel wedge and carbon heel with acetone, then permanently attach the heel wedge to the carbon heel (but not to the shank) using the instant adhesive that was provided with the foot.

Avoid getting acetone on the Fusion graphic on the shank. Acetone will destroy the graphic.



OHIO WILLOW WOOD®

free the body...free the spirit®

15441 Scioto Darby Road

Mt. Sterling, Ohio 43143 USA

Phone: 740.869.3377 or 800.848.4930

Fax: 740.869.4374 <http://www.owwco.com>

Adjusting the Heel Resistance



1. Walk the patient to determine whether the stiffness of the heel is appropriate.
2. If desired, snap a heel wedge into place between the shank and the head of the heel shoulder bolt (refer to the pictures on the back of this page). Walk the patient again.

Note: for this step, it is not necessary to apply the adhesive that is supplied with the foot. The heel is held in place firmly enough to suffice for a temporary fitting situation.

3. To increase the stiffness of the heel, insert a larger heel wedge; to decrease the stiffness, insert a smaller heel wedge.
4. Once the appropriate heel wedge has been determined, clean the heel wedge and carbon heel with acetone, then permanently attach the heel wedge to the carbon heel (but not to the shank) using the instant adhesive that was provided with the foot.

Avoid getting acetone on the Fusion graphic on the shank. Acetone will destroy the graphic.



OHIO WILLOW WOOD®

free the body...free the spirit®

15441 Scioto Darby Road

Mt. Sterling, Ohio 43143 USA

Phone: 740.869.3377 or 800.848.4930

Fax: 740.869.4374 <http://www.owwco.com>

Large heel wedge
= firm heel stiffness

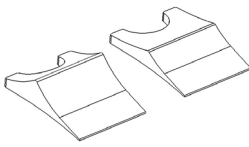

Medium heel wedge
= medium heel stiffness

No heel wedge = soft heel stiffness

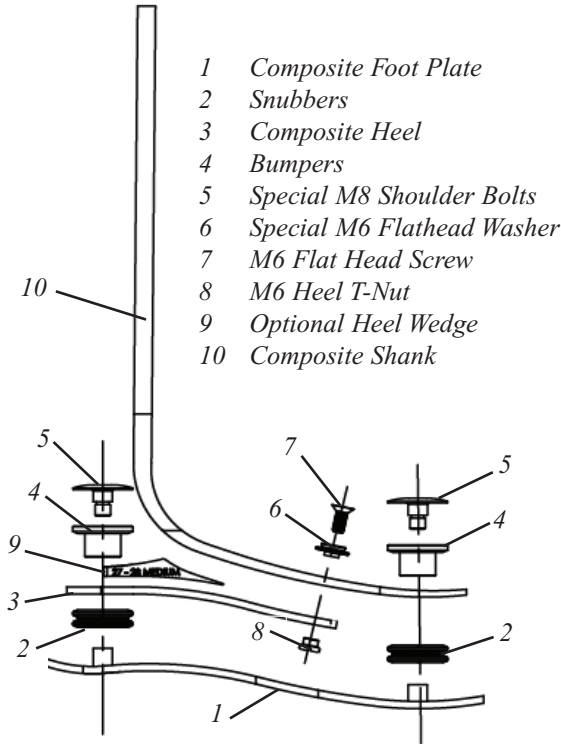

PN-2105-A 20 AUG 2008

Large heel wedge
= firm heel stiffness

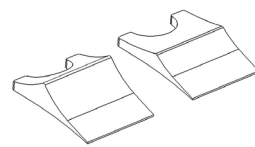

Medium heel wedge
= medium heel stiffness

No heel wedge = soft heel stiffness

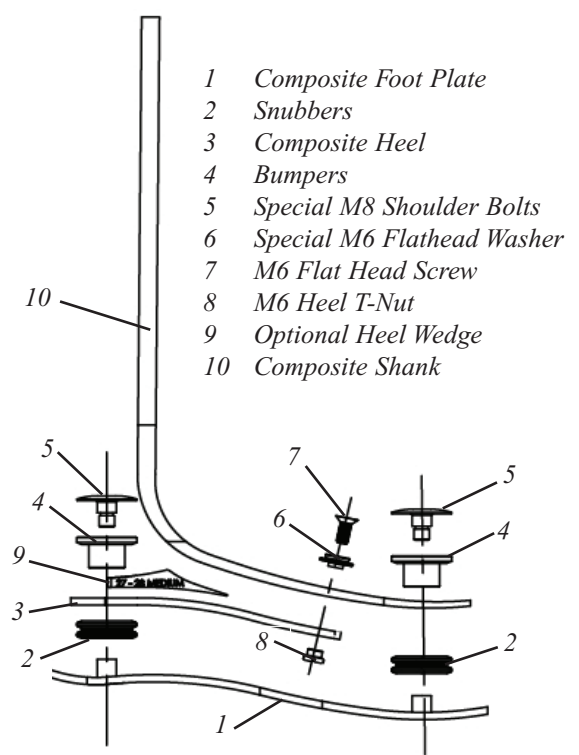

PN-2105-A 20 AUG 2008

Large heel wedge
= firm heel stiffness

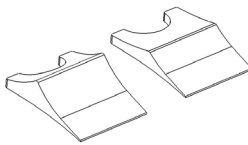

Medium heel wedge
= medium heel stiffness

No heel wedge = soft heel stiffness

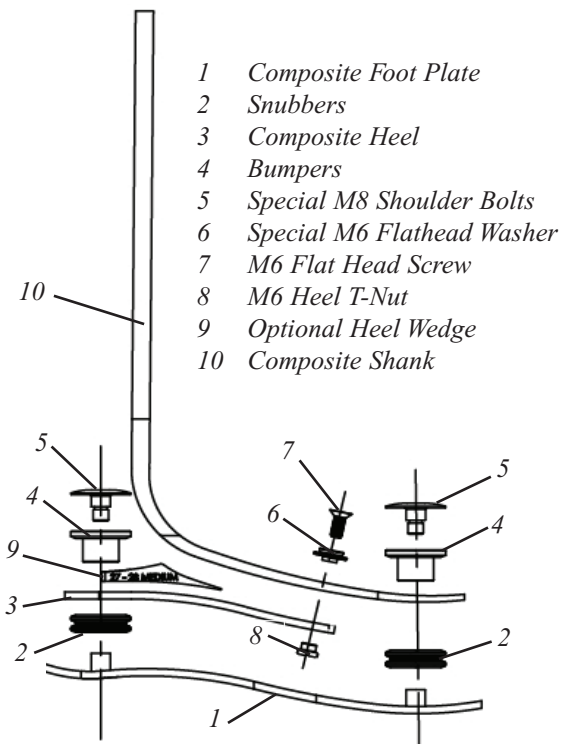

PN-2105-A 20 AUG 2008

Large heel wedge
= firm heel stiffness

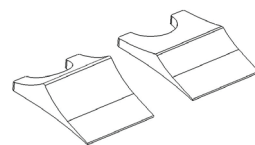

Medium heel wedge
= medium heel stiffness

No heel wedge = soft heel stiffness

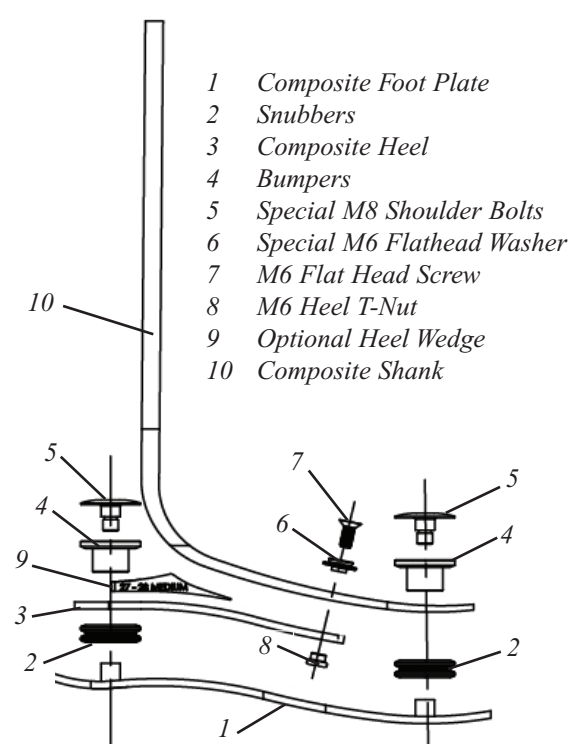

PN-2105-A 20 AUG 2008