

Pathfinder® II Pneumatic Heel Spring Replacement Instructions

WHAT'S IN THE BOX

One of the following:

Pneumatic Heel Spring for Pathfinder II (PFD-1108)

Pneumatic Heel Spring for Low-Profile Pathfinder II (PFD-1109)

Bearing Kit

Grease

Loctite Threadlocker 242

Instructions

ADDITIONAL TOOL NEEDED

4 mm hex wrench

Perform the following procedure to replace a Pneumatic Heel Spring (PHS) that has developed a drop in performance, or to replace the PHS Thrust Bearings or Rubber O-Rings.

1. Using a 4 mm hex wrench, remove the two screws at the distal end of the Pneumatic Heel Spring.

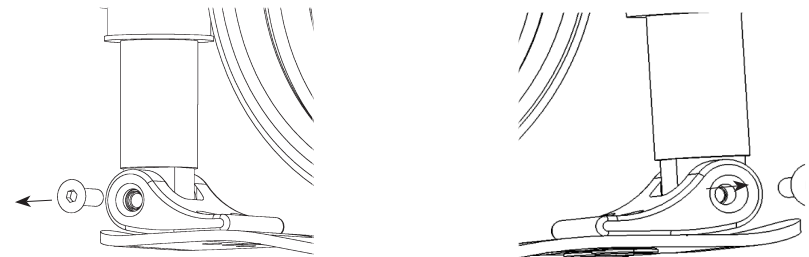

2. Repeat Step 1 for the two screws at the proximal end of the Pneumatic Heel Spring.
3. Remove the Pneumatic Heel Spring from the foot.

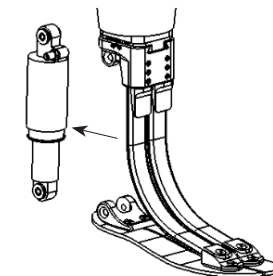

WillowWood®

The Ohio Willow Wood Company
15441 Scioto Darby Road
Mt. Sterling, OH 43143
phone 740.869.3377 / 800.848.4930
fax 740.869.4374 www.willowwoodco.com
Patent www.willowwoodco.com/education-and-resources/patents



Ohio Willow Wood Company B.V.
Keizersgracht 62/64
1015 CS Amsterdam
The Netherlands

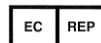

4. Remove the Thrust Washers and O-Rings from either side of the distal end of the Pneumatic Heel Spring.

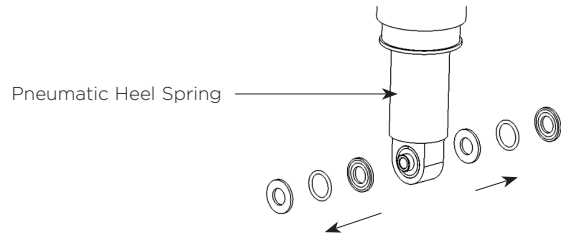

5. Press the Shock Pin with the Rubber Axle out of the distal end of the Pneumatic Heel Spring.

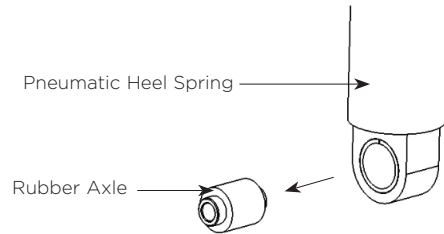

6. Repeat steps 4 and 5 for the proximal end of the Pneumatic Heel Spring.
7. Apply the grease that was included with the replacement kit to each of the Rubber Axles.

Apply grease here.

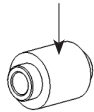

8. Press one Shock Pin with a Rubber Axle into the replacement Pneumatic Heel Spring at the distal end, and one at the proximal end.

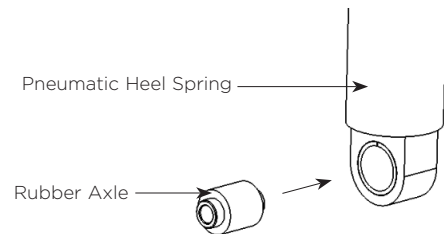

9. Place the Thrust Washers and O-Rings onto the Pneumatic Heel Spring. Make sure the O-Ring fits into the groove on the inner surface of each Thrust Washer.

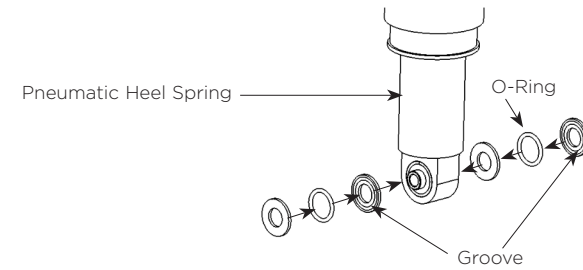

10. Insert the proximal end of the Pneumatic Heel Spring into the proximal connector. Apply Loctite Removable Threadlocker 242 to the two screws, then reinstall the two screws at the proximal end. Repeat this process for the distal end. This will be a tight fit. Compression of the Pneumatic Heel Spring may be required.

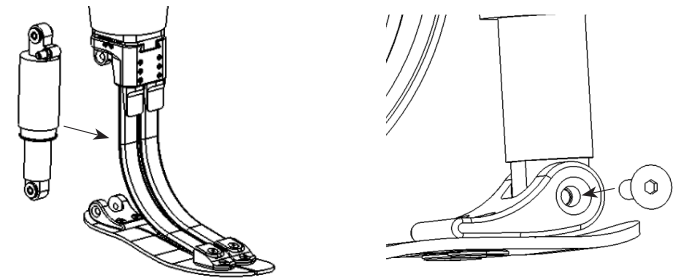

11. Tighten each of the four screws to 110 in-lbs (12 Nm).